

D954SW General Specification.

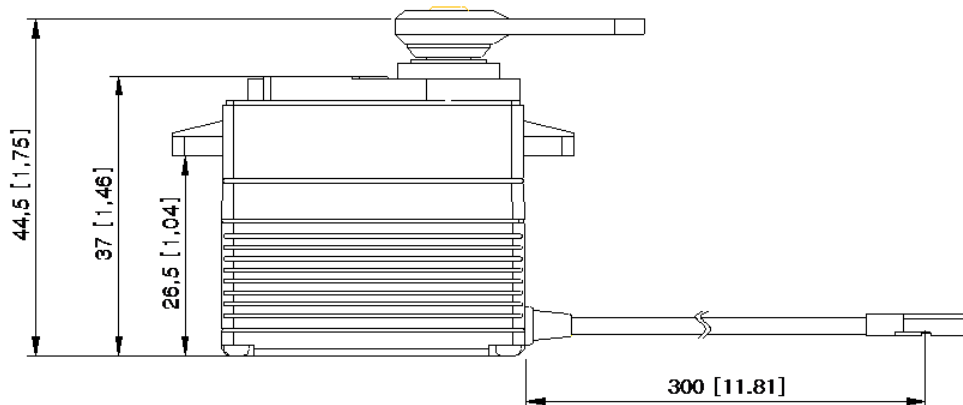

MIGHTY TORQUE SERVO

Control system	PWM			-
Position sensor type	Contact Analog Potentiometer			-
Operating voltage range	4.8 ~ 7.4 V			-
Motor type	Coreless Metal Brush			-
Voltage	4.8V	6.0V	7.4V	At 25°C, 45% ($\pm 10\%$) measurement environment
No load speed	0.19sec/60°	0.15sec/60°	0.12sec/60°	
Stall torque	18.0 kgf·cm(249.97oz-in)	24.0 kgf·cm(333.3 oz-in)	29.0 kgf·cm(402.73oz-in)	
Standing current	30mA	30mA	30mA	
No load running current	300mA	400mA	500mA	
Stall current	3,200mA	4,200mA	5,200mA	
Dead band width	1usec	1usec	1usec	
Operating travel	$\pm 40^\circ$ /One side pulse traveing 400usec			-
Operating temperature range	-20°C ~ +60°C (-4°F ~ +140°F)			-
Vibrations at no load	-			-
Storage temperature range	-30°C ~ +80°C (-31°F ~ +176°F)			-
Connector wire length	300mm (11.81inch)			
Connector wire gauge	20AWG			
Dimensions	40.0 mm x 20.0 mm x 37.0 mm (1.57inch x 0.78inch x 1.45inch)			Refer to the tolerance information
Weight	65.0 g(2.29oz)			Excluding the weight of Horn
Ball bearing	2 Ball Bearing			-
Case material	Engineering Plastic & Aluminum Heat Sink			-
Gear material	1 Metal + Plastic & 3 Steel			-
Gear train backlash	Max 0.5°			-
Horn gear spline	25T(Ø6)			-
IP rate	-			-
Servo Amplifier type	32bit programmable Digital			-
Features				
Applications				

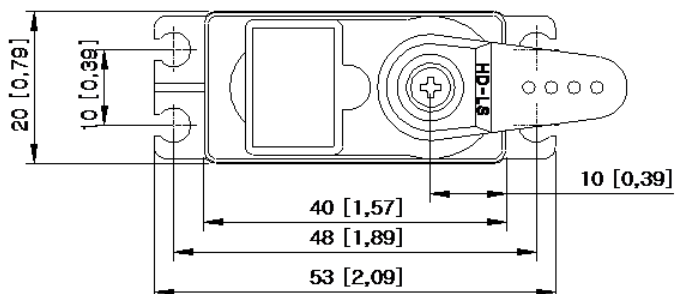

Tolerance ,Unless Otherwise stated is	
Above 0.5 to and Including 9.0	± 0.05
Excess 9 to and Including 120	± 0.1
Excess 120 to and Including 315	± 0.2
Excess 315 to and Including 1000	± 1
Excess 1000 to and Including 2000	± 2

1:1 scale (unit : mm)



<https://hitec.com>